

# VELAN MONOVALVE FLOAT BIMETALLIC STEAM TRAPS

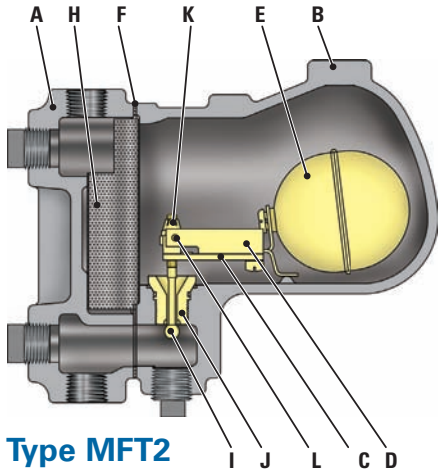

Type MFT2

## STANDARD MATERIALS

PART	MATERIALS
A	Body
B	Cover
C	Bimetal element
D	Bimetal holder
E	Float
F	Cover gasket
G	Cover screw
H	Strainer
I	Stem and ball
J	Seat
K	Self lock adjusting nut
L	Pivot plug

NOTE: Part 'G' is not shown for clarity.

## APPLICATIONS

Where positive drainage is essential and condensate back-up cannot be tolerated.

- Unit heaters,
- Laundry presses,
- Calorifiers,
- Ironers,
- Calenders,
- Drying cylinders and other applications where condensate has to be discharged at near steam temperature.

## CONNECTIONS

- Screwed

## ENGINEERING DATA

PRESSURE RANGE <sup>(1)</sup> psi/bar	PMO psi/bar	MATERIAL	MAX TEMP °F/°C	ORIFICE in/mm	MAX CAPACITY lb/hr/kg/hr
0-15 0-1	15 1	CAST IRON Gr.250	428 220	1/2 12.7	7,000 3,182
15-50 1-3.5	50 3.5			5/16 8	3,200 1,455
50-125 3.5-8.5	125 8.5			1/4 6.4	2,600 1,182
125-200 8.5-14	200 14			7/32 5.5	2,000 909

PMA = Maximum allowable pressure: 260psi@100°F (18bar.g@38°C)

TMA = Maximum allowable temperature: 428°F (220°C)

Maximum cold hydrostatic test pressure: 400psi.g (27.5bar)

TMO = Maximum operating temperature = TMA

PMO = Maximum operating pressure: See Table

(1) Pressure range indicated in the above table is the preferred operating range, however the trap is functional from Ops to its maximum operating pressure.

## DIMENSIONS & WEIGHTS

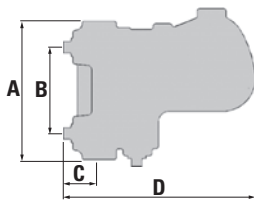

SIZE in/mm	A <sup>(1)</sup> FACE TO FACE	B <sup>(2)</sup> CENTER TO CENTER	C <sup>(3)</sup> CENTER TO FACE	D LENGTH	WEIGHT lb/kg
3/4 1	7 11/16	4 3/4	1 7/16	9 3/8	15
20 25	195	121	37	238	7
1 1/4 1 1/2	8 203	4 1/2 114	1 3/4 44	10 3/8 264	17 8

(1) Vertical connection. (2) Horizontal connection. (3) Center of vertical outlet to face of horizontal outlet.

## CONDENSATE CAPACITY

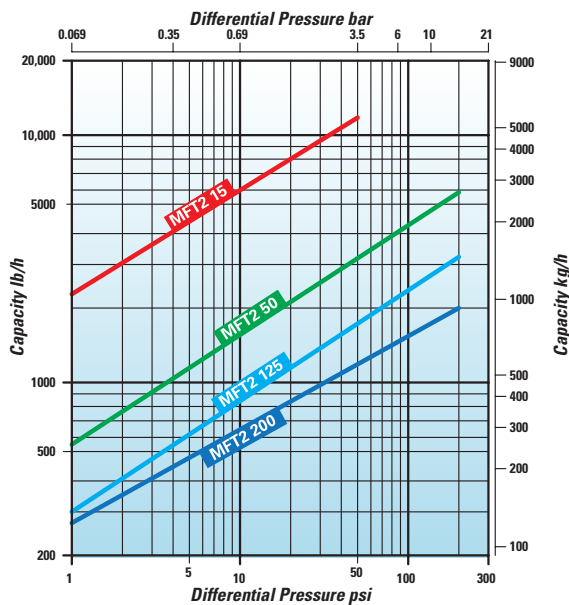

Maximum cold water capacity x 3.5

The performance graph indicates the continuous discharge capacities of condensate per hour at various pressure differentials across the trap.

## PRESSURE / TEMPERATURE LIMITS

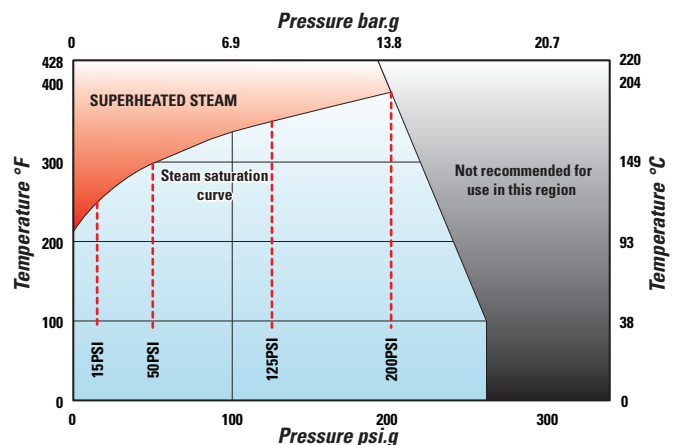

----- Pressure limit for trap type